

Assembly Instructions
MODEL NO. : N 112
2 DRAWER LATERAL FILE

Thank you for purchasing the "N" product.

<p>A</p>  <p>Adjustable Glide 4 Pcs</p>	<p>B</p>  <p>Rivets Metal Screws 4 Pcs</p>	<p>C</p>  <p>File Clip 8 Pcs</p>	<p>D</p>  <p>6.72 x 16 x 3mm Aluminium Bar 2 Pcs</p>	<p>E</p>  <p>378 x 16 x 3mm Aluminium Bar 4 Pcs</p>	<p>F</p>  <p>Screw 1 Set</p>
---	--	--	--	---	--

STEP 1

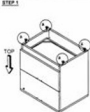

COMPLETED ASSEMBLY

STEP 2



IMPORTANT NOTE :

- Place all wooden parts on a clean and smooth surface such as a rug or carpet to avoid the parts from being scratched.
- Check to be sure that you have all parts and hardware.
- Remove all wrapping materials, including staples & packing straps before you start to assemble.
- Do not tighten all screws/bolts until all completely assembled.
- Keep all hardware parts out of reach of children.