

Assembly Instructions
MODEL NO.: N180
 GALLERY RETURN

10/18

| ITEM NO. | ITEM NAME | QUANTITY | ITEM NO. | ITEM NAME | QUANTITY | ITEM NO. | ITEM NAME | QUANTITY | ITEM NO. | ITEM NAME | QUANTITY | | | |
|----------|-----------------|----------|----------|----------------------------|----------|----------|---------------|----------|----------|-----------------------------|----------|---|---------------|---|
| A | Cam Lock PCB | 1 | D | Adjustable Cam PCB | 1 | G | Staple PCB | 1 | H | Staple Back Cover PCB | 1 | I | Staple PCB | 1 |
| B | Key Cam PCB | 1 | E | 5 Hole 1 Bracket PCB | 1 | H | Staple PCB | 1 | I | Staple PCB | 1 | | | |

STEP 1

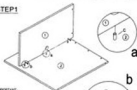

Important:

FUNCTION OF ALFA CAM



1/4 RIGHT
TURN FOR
LOCKING

1/4 LEFT
TURN FOR
UNLOCKING

STEP 2

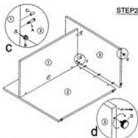

STEP 3



STEP 4

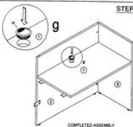

COMPLETED ASSEMBLY

IMPORTANT NOTE:

- Place all laminated parts on a clean and smooth surface such as a rug or carpet to avoid the parts from being scratched.
- Check to be sure that you have all parts and hardware.
- Remove all wrapping materials, including staples & packing straps before you start to assemble.