

# CHAIR SETUP INSTRUCTIONS

MODEL: B800 H1

## Step 1

Insert the Gas Lift into the base

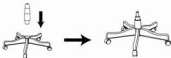

## Step 2

Place the Chair onto the Base



Insert and loosely tighten all screws. When assembly is completed, fully tighten all screws before using. This chair is only intended for sitting. Any other use will void the warranty.

Customer Service Hotline: 1-800-550-1888

For further assembly instructions,  
please visit our website at [www.koonohub.com](http://www.koonohub.com)